

Grizzly *Industrial, Inc.*®

MODEL H7830/H7831

ARBOR PRESS

OWNER'S MANUAL

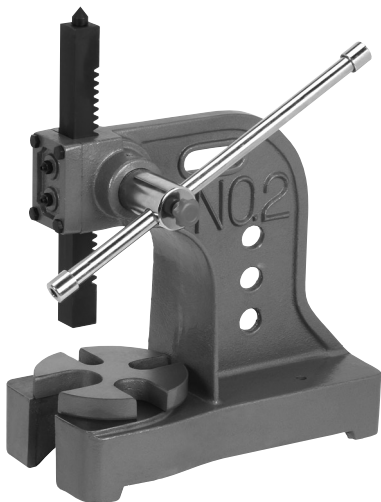

Model H7830 — 2 Ton Arbor Press

Model H7831 — 3 Ton Arbor Press



COPYRIGHT © OCTOBER, 2005 BY GRIZZLY INDUSTRIAL, INC.
**WARNING: NO PORTION OF THIS MANUAL MAY BE REPRODUCED IN ANY SHAPE
OR FORM WITHOUT THE WRITTEN APPROVAL OF GRIZZLY INDUSTRIAL, INC.**

#TR7642 PRINTED IN CHINA

SAFETY

WARNING

For Your Own Safety Read Instruction Manual Before Operating This Equipment

The purpose of safety symbols is to attract your attention to possible hazardous conditions. This manual uses a series of symbols and signal words which are intended to convey the level of importance of the safety messages. The progression of symbols is described below. Remember that safety messages by themselves do not eliminate danger and are not a substitute for proper accident prevention measures.

DANGER

Indicates an imminently hazardous situation which, if not avoided, WILL result in death or serious injury.

WARNING

Indicates a potentially hazardous situation which, if not avoided, COULD result in death or serious injury.

CAUTION

Indicates a potentially hazardous situation which, if not avoided, MAY result in minor or moderate injury. It may also be used to alert against unsafe practices.

NOTICE

This symbol is used to alert the user to useful information about proper operation of the equipment.

WARNING

Safety Instructions for Arbor Presses

- 1. OWNER'S MANUAL.** This equipment presents serious injury hazards to untrained users. Read through the entire manual BEFORE using.
- 2. SAFETY GLASSES.** Workpiece may "pop" out of arbor press and become a dangerous projectile. Always use ANSI approved safety glasses or a face shield when using this equipment.
- 3. CRUSH/PINCH HAZARD.** This equipment can easily crush or pinch hands near the point of operation or where the rack slides in the casting. Keep hands away from these areas!
- 4. TIPPING HAZARD.** The arbor press requires a lot of leverage when using. Always securely anchor it to the workbench or stand before using.
- 5. ADDED LEVERAGE.** Increasing leverage by using a longer handle or "cheater" bar creates more force than intended for the equipment design, which may result in a serious personal injury or a broken casting.
- 6. ONE PERSON OPERATION.** Unintentional crushing injuries may occur if multiple people use this press at a time. This machine should only be operated by one person at a time.

INTRODUCTION

Foreword

We are proud to offer the Grizzly Model H7830/H7831 Arbor Press. When used according to the guidelines set forth in this manual, you can expect years of trouble-free, enjoyable operation and proof of Grizzly's commitment to customer satisfaction.

It is our pleasure to provide this manual with the Model H7830/H7831. It was written to encourage safety considerations and guide you through general operating procedures and maintenance.

The specifications, details, and photographs in this manual represent the Model H7830/H7831 as supplied when the manual was prepared. However, owing to Grizzly's policy of continuous improvement, changes may be made at any time with no obligation on the part of Grizzly.

Specifications

H7830

Press Capacity 2 Tons
Throat 5 $\frac{3}{4}$ "
Maximum Working Height 6 $\frac{3}{4}$ "
Bore Size 0.5" Dia. x 0.85" Deep
Weight 75 LBS

H7831

Press Capacity 3 Tons
Throat 6 $\frac{5}{8}$ "
Maximum Working Height 11 $\frac{3}{4}$ "
Bore Size 0.5" Dia. x 0.85" Deep
Weight 122 LBS

Contact Information

If you have any comments regarding this manual, please write to us at the following address:

Grizzly Industrial, Inc.
C/O Technical Documentation
P.O. Box 2069
Bellingham, WA 98227-2069

Most importantly, we stand behind our tools. If you have any service questions or parts requests, please call or write us at the location listed below.

Grizzly Industrial, Inc.
1203 Lycorning Mall Circle
Muncy, PA 17756
Phone: (570) 546-9663
Fax: (800) 438-5901
E-Mail: techsupport@grizzly.com
Web Site: <http://www.grizzly.com>

WARNING

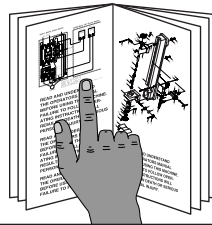

Read the manual before operation. Become familiar with this machine, its safety instructions, and its operation before beginning any work. Serious personal injury may result if safety or operational information is not understood or followed.

SET UP

Unpacking

Your arbor press left our warehouse in a carefully packed crate or box. If you discover the arbor press is damaged after you have signed for delivery, *please immediately call Customer Service at (570) 546-9663 for advice.*

Save the containers and all packing materials for possible inspection by the carrier or its agent. *Otherwise, filing a freight claim can be difficult.*

Cleaning

The unpainted surfaces are coated with a waxy oil to protect them from corrosion during shipment. Remove this protective coating with a solvent cleaner or citrus-based degreaser such as Grizzly's G7895 Degreaser.

To clean thoroughly, some parts may need to be removed. **For optimum performance from your arbor press, make sure you clean all moving parts or sliding contact surfaces that are coated.** Avoid chlorine-based solvents, such as acetone or brake parts cleaner, as they will damage painted surfaces if they come in contact.

Always follow the manufacturer's instructions when using any type of cleaning product.

Mounting

The arbor press requires a lot of leverage and force to operate, so it **MUST** be securely fastened to a sturdy workbench.

Use the holes shown in **Figure 1** to mount the arbor press to your workbench.

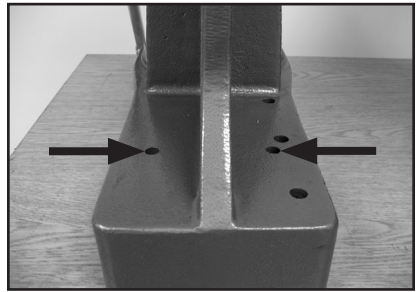

Figure 1. Arbor press mounting holes.

H7832 Optional Stand

This Heavy-duty Stand features a 3 $\frac{1}{4}$ " x 4" x 5" catch box, a 3 $\frac{3}{4}$ " x 3 $\frac{3}{4}$ " tray and cast iron table and base. Table is 36" high. Slots at 4 $\frac{5}{8}$ ", 3 $\frac{7}{8}$ " and 2 $\frac{3}{8}$ " centers. Threaded holes at 3 $\frac{3}{4}$ ", 5 $\frac{1}{2}$ " and 7 $\frac{1}{2}$ " centers.



Call 1-800-523-4777 To Order

Figure 2. Model H7832 optional stand.

OPERATIONS

Job Types

The arbor press can be used for the following jobs:

- Assembly
- Seating & Removing Bearings
- Stamping
- Punching
- Flattening
- Piercing
- Straightening
- Marking
- Cutting
- Bending
- Staking
- Broaching

Table Plate

Simply rotate the table plate on the center pin to use the different openings.

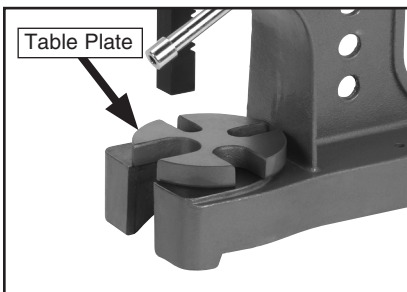

Figure 3. Table plate.

Ram

The ram has a 1/2" hole on one end that will accept custom made piercing and pressing dies.

To use a custom die in the ram:

1. Remove the front support plate and ram, as shown in **Figure 4**.

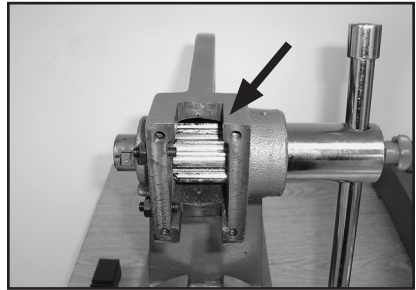

Figure 4. Front support plate and ram removed.

2. Turn the ram upside-down and reinstall it in the arbor press body.
3. Replace the front support plate.
4. Push the die into the ram. It is a friction fit. **Figure 5** shows a die properly installed.

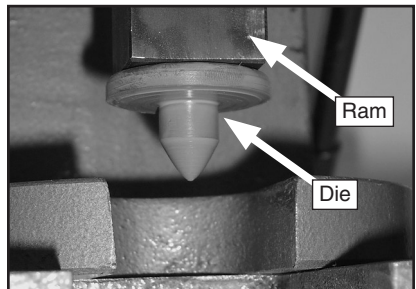

Figure 5. Custom die installed in ram.

MAINTENANCE

Lubricating

Lubricant Recommended

- Multipurpose Grease
- Light Machine Oil

Greasing

1. For best results, clean the ram and pinion to remove old grease or collected grime, if necessary.
2. Raise the ram all the way up and apply a light layer of grease all the way around the ram.
3. Move the ram up and down to distribute the grease.

Oiling

1. For best results, remove the pinion and clean existing oil or collected grime from both the casting and the pinion.
2. Depress the ball fittings shown in **Figure 6** and squeeze a 3–5 drops of oil into the fitting.

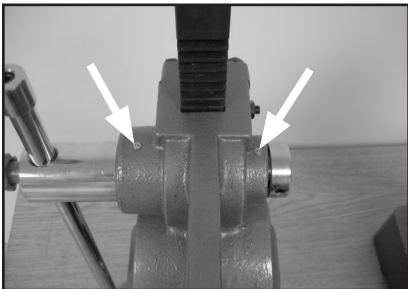

Figure 6. Oil (ball) fittings.

Adjusting Play

Setscrews on the side and front of the casting allow you to adjust the amount of free play the ram has when sliding. This adjustment is an easy procedure that rarely needs to be repeated.

To adjust the play in the ram movement:

1. Loosen the hex nuts on the set screws shown in **Figure 7**.

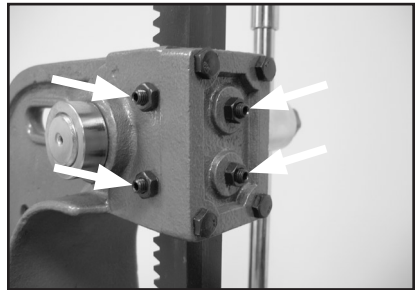

Figure 7. Set screws for adjusting play.

2. Adjust the setscrews a small amount in the same direction (clockwise to decrease play, counterclockwise to increase play) as necessary for the amount of play in your ram.

— Ideally, the ram should move with very little play; however, if the sliding action is too stiff, the setscrews are too tight.

3. Tighten the lock nuts on the setscrews.

PARTS BREAKDOWN

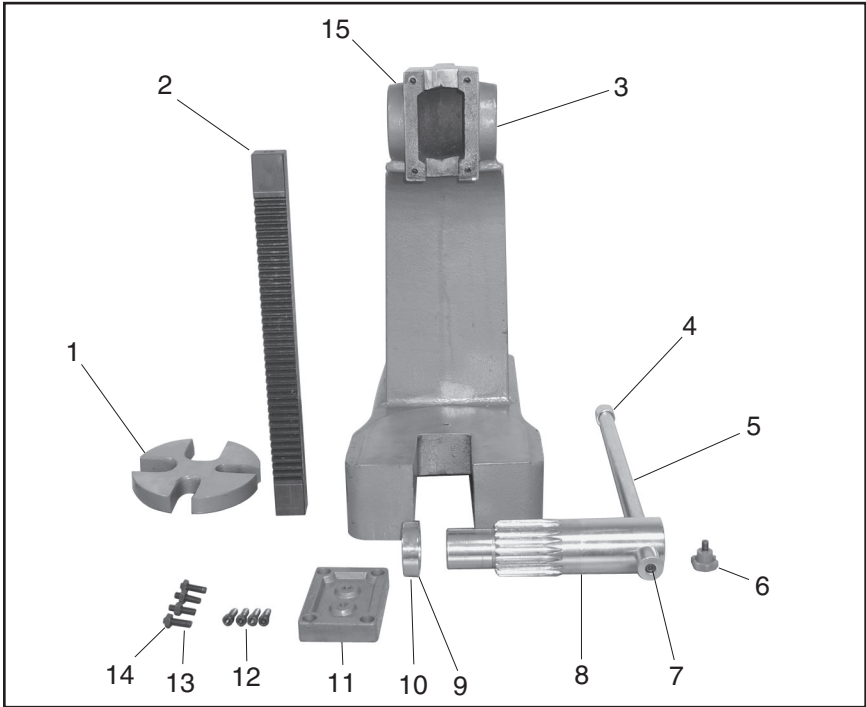

H7830 Parts List

REF	PART #	DESCRIPTION
1	PH7830001	TABLE
2	PH7830002	RAM
3	PH7830003	CAST FRAME
4	PH7830004	HANDLE CAP
5	PH7830005	SLIDING HANDLE
6	PH7830006	LOCK KNOB M8-1.25 X 12
7	PSB02M	CAP SCREW M6-1 X 20
8	PH7830008	PINION
9	PH7830009	LOCK COLLAR
10	PSS20M	SET SCREW M8-1.25 X 8
11	PH7830011	RAM SUPPORT PLATE
12	PB26M	HEX BOLT M8-1.25 X 30
13	PSS19M	SET SCREW M8-1.25 X 30
14	PN03M	HEX NUT M8-1.25
15	PH7830015	OIL FITTING 6MM

H7831 Parts List

REF	PART #	DESCRIPTION
1	PH7830001	TABLE
2	PH7831002	RAM
3	PH7831003	CAST FRAME
4	PH7831004	HANDLE CAP
5	PH7831005	SLIDING HANDLE
6	PH7830006	LOCK KNOB M8-1.25 X 12
7	PSB02M	CAP SCREW M6-1 X 20
8	PH7831008	PINION
9	PH7831009	LOCK COLLAR
10	PSS20M	SET SCREW M8-1.25 X 8
11	PH7831011	RAM SUPPORT PLATE
12	PSB14M	CAP SCREW M8-1.25 X 20
13	PSS19M	SET SCREW M8-1.25 X 30
14	PN03M	HEX NUT M8-1.25
15	PH7830015	OIL FITTING 6MM

WARRANTY & RETURNS

Grizzly Industrial, Inc. warrants every product it sells for a period of **1 year** to the original purchaser from the date of purchase. This warranty does not apply to defects due directly or indirectly to misuse, abuse, negligence, accidents, repairs or alterations or lack of maintenance. This is Grizzly's sole written warranty and any and all warranties that may be implied by law, including any merchantability or fitness, for any particular purpose, are hereby limited to the duration of this written warranty. We do not warrant or represent that the merchandise complies with the provisions of any law or acts unless the manufacturer so warrants. In no event shall Grizzly's liability under this warranty exceed the purchase price paid for the product and any legal actions brought against Grizzly shall be tried in the State of Washington, County of Whatcom.

We shall in no event be liable for death, injuries to persons or property or for incidental, contingent, special, or consequential damages arising from the use of our products.

To take advantage of this warranty, contact us by mail or phone and give us all the details. We will then issue you a "Return Authorization Number," which must be clearly posted on the outside as well as the inside of the carton. We will not accept any item back without this number. Proof of purchase must accompany the merchandise.

The manufacturers reserve the right to change specifications at any time because they constantly strive to achieve better quality equipment. We make every effort to ensure that our products meet high quality and durability standards and we hope you never need to use this warranty.

Thank you again for your business and continued support. We hope to serve you again soon!



WARRANTY CARD

Name _____

Street _____

City _____ State _____ Zip _____

Phone # _____ Email _____ Invoice # _____

Model # _____ Order # _____ Serial # _____

*The following information is given on a voluntary basis. It will be used for marketing purposes to help us develop better products and services. **All information is strictly confidential.***

1. How did you learn about us?

Advertisement Friend Catalog
 Card Deck Website Other: _____

2. Which of the following magazines do you subscribe to?

Cabinet Maker Popular Mechanics Today's Homeowner
 Family Handyman Popular Science Wood
 Hand Loader Popular Woodworking Wooden Boat
 Handy Practical Homeowner Woodshop News
 Home Shop Machinist Precision Shooter Woodsmith
 Journal of Light Cont. Projects in Metal Woodwork
 Live Steam RC Modeler Woodworker West
 Model Airplane News Rifle Woodworker's Journal
 Modeltec Shop Notes Other:
 Old House Journal Shotgun News

3. What is your annual household income?

\$20,000-\$29,000 \$30,000-\$39,000 \$40,000-\$49,000
 \$50,000-\$59,000 \$60,000-\$69,000 \$70,000+

4. What is your age group?

20-29 30-39 40-49
 50-59 60-69 70+

5. How long have you been a woodworker/metalworker?

0-2 Years 2-8 Years 8-20 Years 20+ Years

6. How many of your machines or tools are Grizzly?

0-2 3-5 6-9 10+

7. Do you think your machine represents a good value? Yes No

8. Would you recommend Grizzly Industrial to a friend? Yes No

9. Would you allow us to use your name as a reference for our customers in your area?

Note: *We never use names more than 3 times.* Yes No

10. Comments: _____

Send a Grizzly Catalog to a friend:

Name _____
Street _____
City _____ State _____ Zip _____

FOLD ALONG DOTTED LINE

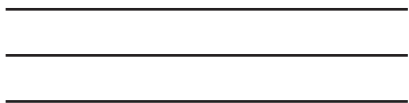

Place
Stamp
Here



GRIZZLY INDUSTRIAL, INC.
P.O. BOX 2069
BELLINGHAM, WA 98227-2069



TAPE ALONG EDGES--PLEASE DO NOT STAPLE

