

Grizzly **Industrial, Inc.**®

MODEL H7817 2000 LB. ELECTRIC WINCH OWNERS' MANUAL



COPYRIGHT © OCTOBER, 2005 GRIZZLY INDUSTRIAL, INC., REV. DECEMBER, 2011 (TR)
WARNING: NO PORTION OF THIS MANUAL MAY BE REPRODUCED IN ANY SHAPE
OR FORM WITHOUT THE WRITTEN APPROVAL OF GRIZZLY INDUSTRIAL, INC.
#JK7695 PRINTED IN CHINA

INTRODUCTION

Foreword

We are proud to offer the Grizzly Model H7817 2000 Lb. Electric Winch. This model is part of a growing Grizzly family of fine power tools. When used according to the guidelines set forth in this manual, you can expect years of trouble-free, enjoyable operation and proof of Grizzly's commitment to customer satisfaction.

The Model H7817 features convenient, portable power for pulling boats, stuck vehicles, and other heavy items. This winch is powered by a 12V DC power supply.

It is our pleasure to provide this manual with the Model H7817. It was written to encourage safety considerations and guide you through general operating procedures and maintenance.

The specifications, details, and photographs in this manual represent the Model H7817 as supplied when the manual was prepared. However, owing to Grizzly's policy of continuous improvement, changes may be made at any time with no obligation on the part of Grizzly.

Machine Data

Pulling Capacity.....	2000 lb.
Line Speed Under Load.....	6 FPM
Cable Size	5/32" x 49'
Power Source	12V Battery

Contact Info

If you have any comments regarding this manual, please write to us at the following address:

Grizzly Industrial, Inc.
C/O Technical Documentation
P.O. Box 2069
Bellingham, WA 98227-2069

Most importantly, we stand behind our tools. If you have any service questions or parts requests, please call or write us at the location listed below.

Grizzly Industrial, Inc.
1203 Lycoming Mall Circle
Muncy, PA 17756
Phone: (570) 546-9663
Fax: (800) 438-5901
E-Mail: techsupport@grizzly.com
Web Site: <http://www.grizzly.com>

WARNING

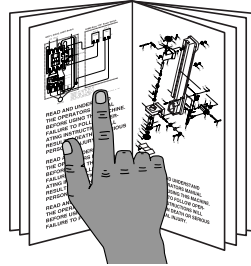

Read the manual before operation. Become familiar with this machine, its safety instructions, and its operation before beginning any work. Serious personal injury may result if safety or operational information is not understood or followed.

WARNING

Safety Instructions for Electric Winches

1. **READ THIS MANUAL:** This manual contains proper operating instructions for this machine.
2. **EYE PROTECTION:** Always wear ANSI approved eye protection when operating winch.
3. **LOOSE CLOTHING:** DO NOT wear loose clothing while operating this machine. Keep hair, jewelry and hands away from operating winch.
4. **CABLE DAMAGE:** Always inspect any slings or pins and the cable for frays, loose connections, or damage. DO NOT use winch if any component is damaged or if the cable is damaged or frayed in any way.
5. **CABLE REPLACEMENT:** DO NOT replace the cable with one of lesser strength. A cable of lesser strength could snap and whip back, causing serious personal injury.
6. **CABLE BREAKAGE:** DO NOT stand in line with or alongside the cable while the winch is operating. If the cable breaks it can whip back and cause serious personal injury.
7. **WINCH LIMITS:** DO NOT attempt to exceed the pulling limits of the winch. Always leave a minimum of five turns (1/2 wrap) of cable on the winch at all times.
8. **SAFETY SPOTTER:** Use a spotter to help ensure safety when using the winch. Be sure the spotter is out of the way of the vehicle and the cable before operating the winch.
9. **HAND ASSISTANCE:** NEVER attempt to assist the winch by pulling on the cable while the winch is running. This can cause serious personal injury.
10. **AUTOMOTIVE BATTERY:** Be sure the battery is in good condition. Always connect the positive (+/RED) cable to the positive (+/RED) battery post first, and then connect the negative (-/BLACK) cable to the vehicle frame.
11. **CABLE PROTECTION:** Always protect the cable and any slings from sharp edges. DO NOT stress the cable or slings by using them on extreme pulling angles.
12. **VEHICLE SAFETY:** NEVER accelerate or reverse the winching vehicle in order to assist in winching operations. This can cause the winch or cable to fail and cause serious personal injury.

SECTION 2: SET UP

Inventory

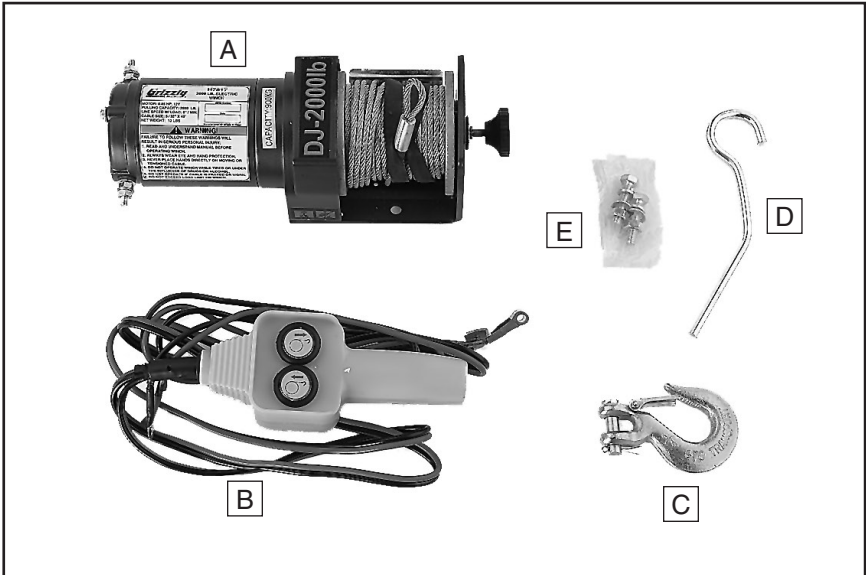

Figure 1. Winch inventory.

Your winch left our warehouse carefully packed. If you discover the winch is damaged after you have signed for delivery, *please immediately call Customer Service at (570) 546-9663 for advice.*

Save the container and packing materials for possible inspection by the carrier or its agent. *Otherwise, filing a freight claim can be difficult.*

When you are completely satisfied with the condition of the shipment, you should inventory the equipment.

After all the parts have been removed from the box, you should have the following items:

Model H7817 Inventory (Figure 1)

- A. Winch 1
- B. Power Cables/Remote Control 1
- C. Winch Hook..... 1
- D. Handsaver Bar 1
- E. Hardware Bag 1

Hardware Bag Contents

- Hex Bolts M8-1.25 x 35 Grade 8.8 ... 2
- Hex Nuts M8-1.25 Grade 8.8 2
- 8mm Flat Washer..... 1
- 8mm Lock Washer 1

In the event that any non-proprietary parts are missing (e.g. a nut or a washer), we would be glad to replace them, or for the sake of expediency, replacements can be obtained at your local hardware store.

Mounting Winch

NOTICE

This winch creates 2000 lbs. of pulling force at the first half-wrap of the cable. Be sure the mounting location is capable of withstanding this amount of force. Reinforcement or modification may be required depending on the mounting location. Failure to comply with this notice could result in damage to your vehicle and/or property.

The winch is designed to be mounted to a standard truck step bumper. The vehicle and bumper must have a minimum towing capacity of 2000 lbs.

To install the winch:

1. Temporarily clamp the winch to the truck bumper with C-clamps.
2. Use the holes in the base of the winch as a guide for drilling two $\frac{3}{8}$ " mounting holes into the bumper.

Note—Avoid drilling into any wiring that may be routed through the inside of the bumper.

3. Mount the winch with the included hex bolts, flat washers, lock washers, and hex nuts, as shown in **Figure 2**, and attach the winch hook to the loop at the end of the cable.

Note—Use a minimum of ISO Grade 8.8 hex bolts, flat washers, lock washers, and hex nuts. Use a thread locking compound such as Loctite® on the bolts.

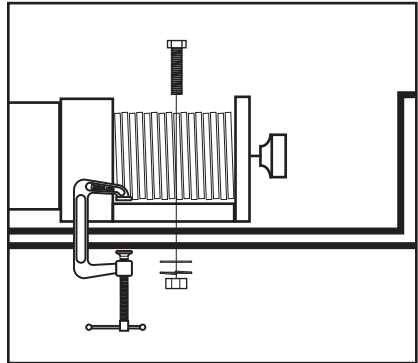

Figure 2. Winch installation.

! WARNING

DO NOT weld or drill additional holes in the winch. This will weaken the winch and may cause it to break.

Wiring

To wire the winch to a 12V vehicle battery:

Note—The four wires connected to the remote control are labeled with either an "electric motor" label or a "battery" label. **DO NOT** attempt to set up the electric winch if any of these labels are missing or damaged – call Grizzly Technical Support at (570) 546-9663 for further assistance.

1. Connect the red wire with the motor tag to the positive (+) terminal of the winch motor, and connect the black wire with the motor tag to the negative (-) terminal of the winch motor, as shown in **Figure 3**.

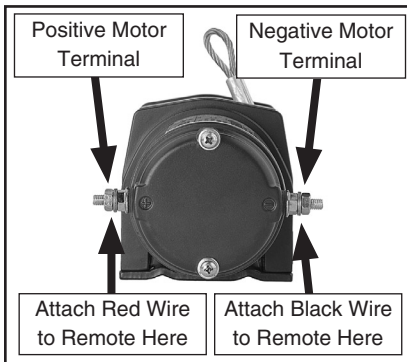

Figure 3. Winch motor terminals.

2. Connect the red wire with the battery tag to the positive (+/RED) terminal of your battery. Connect the black wire with the battery tag to the frame of your vehicle to establish a ground connection.
3. Route the wires through the vehicle in a way that will prevent damage to the wires from chafing, exhaust system and moving parts during operation and maintenance of the vehicle.

4. Set the remote control aside in a safe place until the winch is ready to operate.

Note—If the battery wire connections are incompatible with your battery, they must be replaced with suitable connectors (not included).

!WARNING

IMPORTANT WIRING REMINDERS

1. Always wear ANSI approved safety glasses when operating the winch or working near the 12V battery.
2. Always connect the positive (+/RED) cable to the positive (+/RED) battery post.
3. Always connect the positive cable to the battery FIRST, followed by the black cable to the vehicle frame.
4. Never run the battery dead while using the winch.
5. Never use a battery that is leaking acid or is badly corroded.
6. NEVER attempt to set up or operate the winch without appropriate connections to both the winch motor and the vehicle battery.

Failure to comply with these and other warnings could result in serious personal injury.

NOTICE

If holes are drilled into metal to route power cables, be sure to use rubber grommets to protect the cables from being cut on the sharp metal.

SECTION 3: OPERATIONS

Pulling Capacity

This winch has a pulling capacity of 2,000 lbs at the first half-wrap of the cable. What this means is that when the cable is fully spooled out, with only half of the winch drum wrapped in cable (around 10 turns of the drum), it has a maximum pulling capacity of 2000 lbs.

This maximum capacity will decrease as the line and load are pulled towards the winch. As a general rule, for every full layer of cable on the winch (around 12 feet), you will lose a cumulative 10% of pulling capacity. Because of this, it is highly recommended that you always spool out as much line as possible (within guidelines) prior to winching.

Given ideal winching conditions, you can:

- Move a wheeled load from a “dead” stop of up to 2,000 lbs. on level ground.
- Move up to a 4,800 lb. boat in water.
- Maintain movement of a wheeled vehicle of up to 6,000 lbs.

Winch Operation

To operate the electric winch:

1. Place the vehicle in low gear (manual transmission) or Park (automatic transmission). Put your emergency brake **ON** and block the wheels with chocks.
2. Unlock the cable by pulling the clutch knob out and turning it so that it locks in place, as shown in **Figure 4**.



Figure 4. Clutch knob in free-spooling position.

3. Pull out the amount of cable needed with the handsaver bar. Always leave at least ten turns (a half-wrap) of cable on the winch to prevent it from slipping off under initial tension.
4. Hook onto the pulling object with a pulling point, tow strap, or chain as shown in Figure 5. **DO NOT** wrap the cable around an object and attach the hook to the cable. This can damage the object and fray or kink the cable.
5. Release the clutch knob.

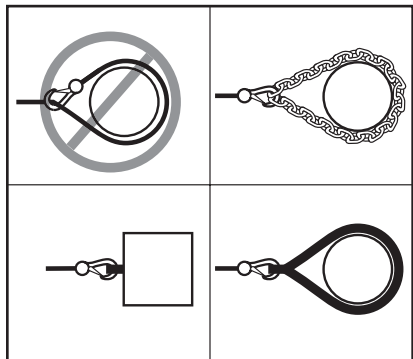

Figure 5. Cable attachment.

6. Start the vehicle engine and let it idle so battery voltage is maintained during winching operations.

6. Stand clear of the cable. Use the remote control to turn the winch **ON** and begin retracting the cable.

Note—For heavy loads, it is highly recommended that you use a pulley block to 'double line' the cable, as shown in **Figure 6**. This will add additional pulling capacity to the cable.

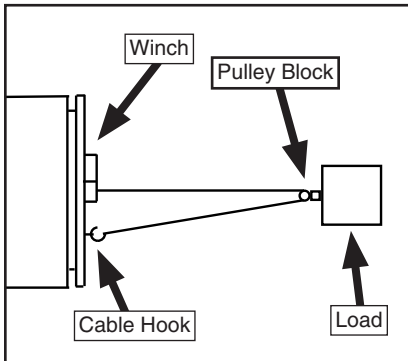

Figure 6. A 'double line' setup.

! WARNING

Never attempt to assist the operating winch by pulling on the cable by hand. This could cause serious personal injury.

Maintenance

1. Occasionally lubricate the cable with a light machine oil.
2. Grease the gears every 6 months. Separate the left and right housing to expose the gears. Use a good quality waterproof grease.
3. Check the cable before each use for signs of kinks or irregular bends in the cable. Kink damage can occur when a loop in the cable is tightened and the cable becomes 'pinched', as shown in **Figure 7**. This significantly weakens the cable strength, and the cable could snap under strain. **DO NOT** use a cable that has signs of kink damage. Doing so could cause serious personal injury.

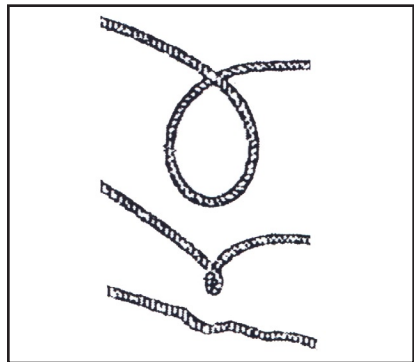

Figure 7. How a cable kink can form.

! WARNING

Before each use, examine the winch and cable for any fray or other damage. Damage to the cable will increase the likelihood of breaking under load, which could cause serious personal injury.

WARRANTY AND RETURNS

Grizzly Industrial, Inc. warrants every product it sells for a period of **1 year** to the original purchaser from the date of purchase. This warranty does not apply to defects due directly or indirectly to misuse, abuse, negligence, accidents, repairs or alterations or lack of maintenance. This is Grizzly's sole written warranty and any and all warranties that may be implied by law, including any merchantability or fitness, for any particular purpose, are hereby limited to the duration of this written warranty. We do not warrant or represent that the merchandise complies with the provisions of any law or acts unless the manufacturer so warrants. In no event shall Grizzly's liability under this warranty exceed the purchase price paid for the product and any legal actions brought against Grizzly shall be tried in the State of Washington, County of Whatcom.

We shall in no event be liable for death, injuries to persons or property or for incidental, contingent, special, or consequential damages arising from the use of our products.

To take advantage of this warranty, contact us by mail or phone and give us all the details. We will then issue you a "Return Authorization Number," which must be clearly posted on the outside as well as the inside of the carton. We will not accept any item back without this number. Proof of purchase must accompany the merchandise.

The manufacturers reserve the right to change specifications at any time because they constantly strive to achieve better quality equipment. We make every effort to ensure that our products meet high quality and durability standards and we hope you never need to use this warranty.

Please feel free to write or call us if you have any questions about the machine or the manual.

Grizzly Industrial, Inc.
1203 Lycoming Mall Circle
Muncy, PA 17756
Phone: (570) 546-9663
Fax: (800) 438-5901

E-Mail:
techsupport@grizzly.com

Web Site: <http://www.grizzly.com>

Thank you again for your business and continued support. We hope to serve you again soon!



WARRANTY CARD

Name _____

Street _____

City _____ State _____ Zip _____

Phone # _____ Email _____ Invoice # _____

Model # _____ Order # _____ Serial # _____

*The following information is given on a voluntary basis. It will be used for marketing purposes to help us develop better products and services. **All information is strictly confidential.***

1. How did you learn about us?

Advertisement Friend Catalog
 Card Deck Website Other: _____

2. Which of the following magazines do you subscribe to?

<input type="checkbox"/> Cabinet Maker	<input type="checkbox"/> Popular Mechanics	<input type="checkbox"/> Today's Homeowner
<input type="checkbox"/> Family Handyman	<input type="checkbox"/> Popular Science	<input type="checkbox"/> Wood
<input type="checkbox"/> Hand Loader	<input type="checkbox"/> Popular Woodworking	<input type="checkbox"/> Wooden Boat
<input type="checkbox"/> Handy	<input type="checkbox"/> Practical Homeowner	<input type="checkbox"/> Woodshop News
<input type="checkbox"/> Home Shop Machinist	<input type="checkbox"/> Precision Shooter	<input type="checkbox"/> Woodsmith
<input type="checkbox"/> Journal of Light Cont.	<input type="checkbox"/> Projects in Metal	<input type="checkbox"/> Woodwork
<input type="checkbox"/> Live Steam	<input type="checkbox"/> RC Modeler	<input type="checkbox"/> Woodworker West
<input type="checkbox"/> Model Airplane News	<input type="checkbox"/> Rifle	<input type="checkbox"/> Woodworker's Journal
<input type="checkbox"/> Modeltec	<input type="checkbox"/> Shop Notes	<input type="checkbox"/> Other:
<input type="checkbox"/> Old House Journal	<input type="checkbox"/> Shotgun News	

3. What is your annual household income?

\$20,000-\$29,000 \$30,000-\$39,000 \$40,000-\$49,000
 \$50,000-\$59,000 \$60,000-\$69,000 \$70,000+

4. What is your age group?

20-29 30-39 40-49
 50-59 60-69 70+

5. How long have you been a woodworker/metalworker?

0-2 Years 2-8 Years 8-20 Years 20+ Years

6. How many of your machines or tools are Grizzly?

0-2 3-5 6-9 10+

7. Do you think your machine represents a good value? Yes No

8. Would you recommend Grizzly Industrial to a friend? Yes No

9. Would you allow us to use your name as a reference for our customers in your area?

Note: *We never use names more than 3 times.* Yes No

10. Comments: _____

Send a Grizzly Catalog to a friend:

Name _____
Street _____
City _____ State _____ Zip _____

FOLD ALONG DOTTED LINE

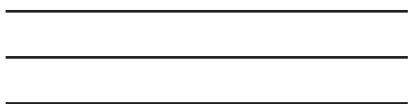

Place
Stamp
Here



GRIZZLY INDUSTRIAL, INC.
P.O. BOX 2069
BELLINGHAM, WA 98227-2069



TAPE ALONG EDGES--PLEASE DO NOT STAPLE

grizzly.com[®]
TOOL WEBSITE

Buy Direct and Save with Grizzly[®] – Trusted, Proven and a Great Value!
~Since 1983~

*Visit Our Website Today For
Current Specials!*

**ORDER
24 HOURS A DAY!
1-800-523-4777**

